

**RENOVATION GENERAL NOTES**

1. COORDINATE WITH OCCUPANTS FOR ALL CONSTRUCTION ACTIVITIES.
2. PATCH, REPAIR, AND/OR REPOINT BRICK WHERE DAMAGED DURING DEMOLITION OR RENOVATION ACTIVITIES. MATCH WITH ADJACENT COLOR, SUBMIT TO ARCHITECT FOR APPROVAL.

**RENOVATION KEYNOTES**

- ① RE-INSTALL THE EXISTING OPAQUE PANEL/FRAME AFTER WINDOW INSTALLATION IS COMPLETE.
- ② RE-INSTALL THE EXISTING WINDOW BLINDS AFTER WINDOW INSTALLATION IS COMPLETE.
- ③ REPAIR GYPSUM AND PAINT AFTER WINDOW INSTALLATION, SEE WINDOW DETAILS.
- ④ TEMPORARY CONSTRUCTION BARRIER.
- ⑤ EXISTING LOUVER TO REMAIN.
- ⑥ NEW STEEL FRAMING. SEE STRUCT. DWG'S.
- ⑦ VIETNAM WAR/MIA EXHIBIT. PROTECT FROM DAMAGE DURING DEMOLITION AND RENOVATION ACTIVITIES.
- ⑧ NEW CONCRETE SITE PAVING. SEE CIVIL DRAWINGS.
- ⑨ EXISTING STRUCTURAL MEMBERS, WRAPPED WITH METAL FRAMING AND GYP. BD.
- ⑩ NEW PVC ROOFING ON TAPERED INSULATION. SEE ROOFING DRAWINGS. REMOVE ALL UNNECESSARY EQUIPMENT. PROTECT NEW ROOF MEMBRANE FROM ALL EXISTING TO REMAIN EQUIPMENT PER MANUFACTURER RECOMMENDATIONS.
- ⑪ NEW SSM ROOFING AND INSULATION. SEE ROOFING DRAWINGS.
- ⑫ NEW DORMER WITH STEEL AND METAL STUD FRAMING.
- ⑬ COORDINATE NEW AND EXISTING DOWNSPOUTS WITH NEW CAST IRON STORM DRAINAGE BOOTS. SEE CIVIL DRAWINGS.
- ⑭ GRIND SMOOTH AND POLISH CONCRETE SLAB FLOOR AFTER QUARRY TILE REMOVAL.
- ⑮ NEW CONCRETE SLAB PATCH. POLISH TO MATCH ADJACENT FLOORS.
- ⑯ SAND, PRIME, AND PAINT EXISTING DOOR.
- ⑰ NEW ROOF LADDER/STAIR. SEE A4.4 FOR DETAILS.
- ⑱ REPAINT CEILING.
- ⑲ OVERHEAD FIRE SHUTTER, SEE A4.71 FOR DETAILS.
- ⑳ NEW 3 HR RATED DOOR IN EXISTING OPENING.



Design/Planning/Construction  
 1201 Main Street, Suite 2100  
 Columbia, S.C. 29201  
 tel. 803-256-0000  
 fax 803-255-7243

ALL RIGHTS RESERVED. THIS DRAWING AND THE DESIGN SHOWN THEREON ARE COPYRIGHTED AS PRESCRIBED BY THE LAWS OF THE UNITED STATES AND ARE THE PROPERTY OF GMK ASSOCIATES ARCHITECTURAL DIVISION. ANYONE DUPLICATING, REPRODUCING OR CAUSING TO BE REPRODUCED THE WHOLE OR PART OF THESE DRAWINGS OR THE DESIGN THEREON WITHOUT PERMISSION OF THE ARCHITECT WILL BE SUBJECT TO LEGAL ACTION.

consultants

client



THE SOUTH CAROLINA DEPARTMENT OF ADMINISTRATION  
 State Project #D50-6037-PD

project name  
**COLUMBIA MILLS ROOF REPLACEMENT & ATRIUM ROOF/WINDOW REPLACEMENT**

A/E project number  
 20058.01

seals/signature

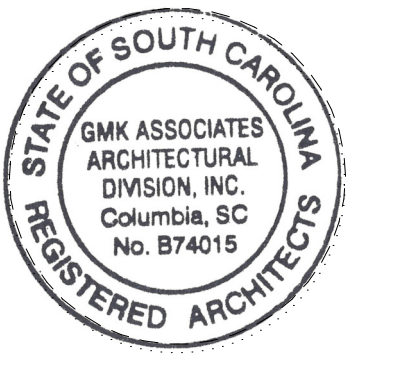

issued for  
**CONSTRUCTION DOCUMENTS**

date  
 APRIL 14, 2022

number	item	date

key plan

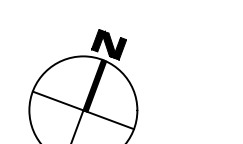
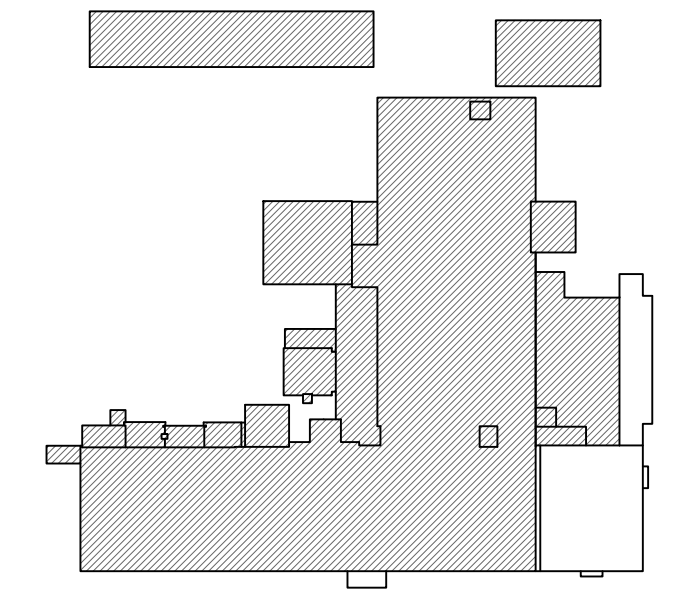

sheet title  
**BASEMENT FLOOR RENOVATION PLAN**

sheet number

**A2.0**

drawn by TLD  
 checked by DBW

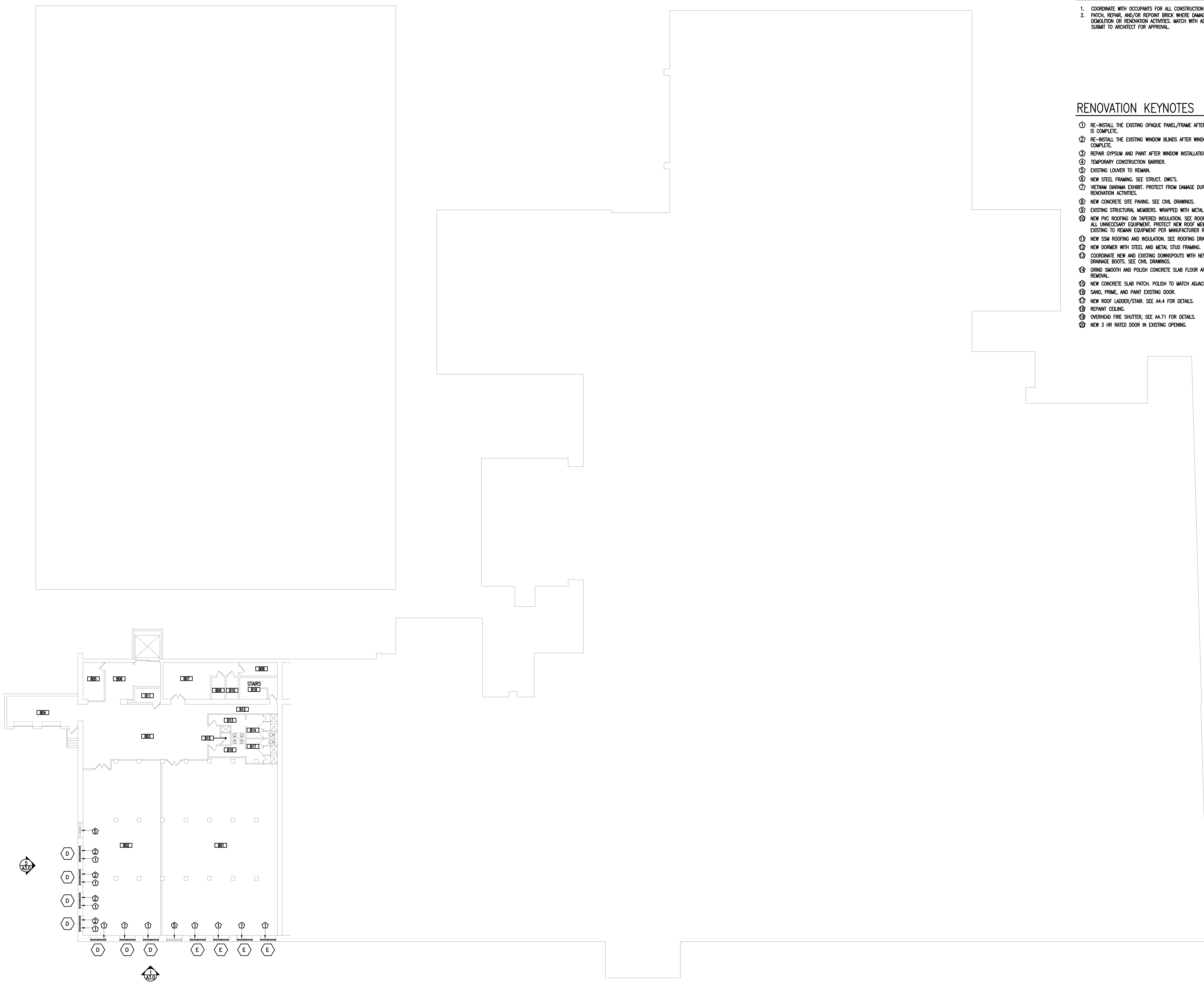

**1 BASEMENT FLOOR RENOVATION PLAN**  
 SCALE: 1/16" = 1'-0"