

consultants

F&ME
Consultants
1825 Blanding Street
Columbia, SC
29201
803.254.4540
www.fmeconsultants.com



client

admin
THE SOUTH CAROLINA
DEPARTMENT of ADMINISTRATION

THE SOUTH CAROLINA
DEPARTMENT OF
ADMINISTRATION
State Project #D50-6037-PD

project name
COLUMBIA MILLS ROOF
REPLACEMENT & ATRIUM ROOF/
WINDOW REPLACEMENT

A/E project number
20058.01

scale/signature

issued for
CONSTRUCTION DOCUMENTS

date
APRIL 18, 2022

number	item	date

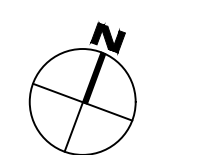
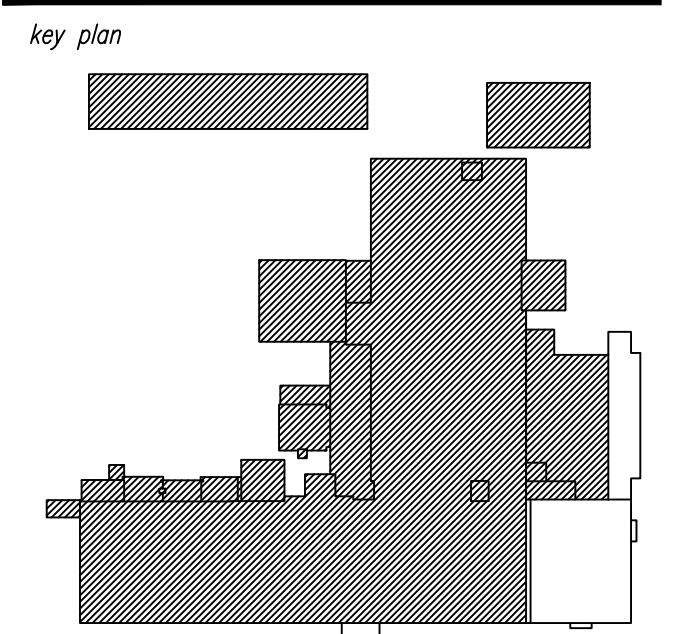

sheet title
EXTERIOR LBP REMEDIATION PLAN

sheet number

AB-2.0

drawn by: MSM
checked by: GME

Contractor to remove loose, flaking, peeling, and cracked exterior LBP from the roof beams (rafter tails, soffit, and fascia) down to stable paint layer. Where wood is found to be damaged, Contractor to consult with GC and Owner's Representative as to the limits of removal. Where wood is removed, Contractor to temporarily seal areas open to the interior of the Building to protect interior surfaces from damage and exposure to the elements.

Contractor to remove loose, flaking, peeling, and cracked exterior LBP from the roof beams (rafter tails, soffit, and fascia) down to stable paint layer. Where wood is found to be damaged, Contractor to consult with GC and Owner's Representative as to the limits of removal. Where wood is removed, Contractor to temporarily seal areas open to the interior of the Building to protect interior surfaces from damage and exposure to the elements.

6 PARTIAL INTERIOR ATRIUM ELEVATION FACING SOUTH
SCALE: 1/16" = 1'-0"

4 NORTH ELEVATION
SCALE: 1/16" = 1'-0"

5 WEST ELEVATION
SCALE: 1/16" = 1'-0"

Limit of Remediation

