

number	item	date

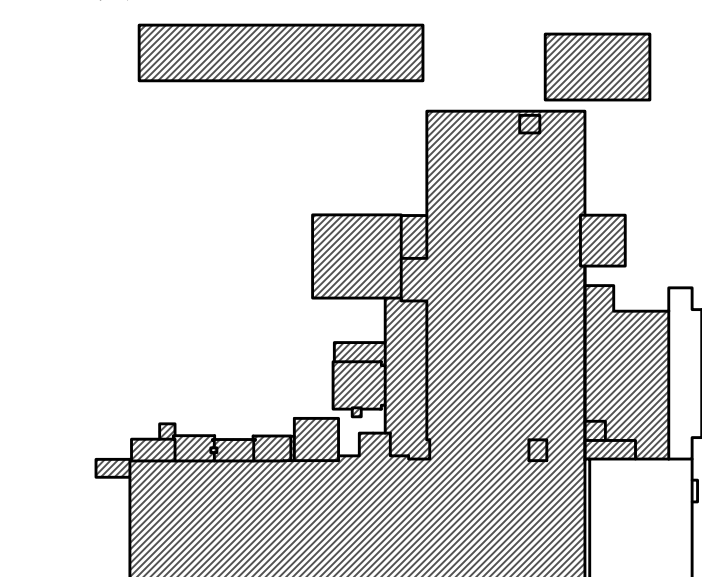

LIGHT FIXTURE SCHEDULE					
TYPE	DESCRIPTION	MANUFACTURER (OR EQUAL)	LAMPS	WATTAGE	NOTES
P	LED PENDANT MOUNT HIGH OUTPUT CYLINDER FIXTURE, FINISH TO SELECTED BY ARCHITECT.	HE WILLIAMS #BCR-TL-L100-835-xxx-DIM-UNV-OW-OF-CS-FMxx	LED BY MFR.	89.8	
C	6" LED SURFACE MOUNTED CYLINDER FIXTURE, FINISH TO BE SELECTED BY ARCHITECT.	GOTHAM #EV06SC-35/40-AR-WD-LD-MVOLT	LED BY MFR.	39.0	
D	6" LED RECESSED DOWNLIGHT AND HOUSING, 1000 LUMEN OUTPUT, 3500K COLOR TEMPERATURE, MEDIUM DISTRIBUTION, SEMI-SPECULAR CLEAR FINISH, POLISHED FLANGE.	HE WILLIAMS #6DR-TL-L10/835-05-DIM1-UNV-OW-OF-CS-N-F1	LED BY MFR.	8.7	
EX	EDGE LIT EXIT SIGN WITH RED LETTERING AND ALUMINUM HOUSING.	HE WILLIAMS #EXIT/EL-R-CP-AN-EM-SOT-D	LED BY MFR.	5	
LP1	10' LED PENDANT LINEAR FIXTURE, 842 LUMEN PER FOOT OUTPUT, 3500K COLOR TEMPERATURE, WITH WIDE DISTRIBUTION UP LIGHT COMPONENT.	FINELITE #HPX-P-D-10'-S-S-835-WSOTG-F-UNV-SC-FC-10X-FA50*	LED BY MFR.	68	
LP2	8' LED PENDANT LINEAR FIXTURE, 842 LUMEN PER FOOT OUTPUT, 3500K COLOR TEMPERATURE, WITH WIDE DISTRIBUTION UP LIGHT COMPONENT.	FINELITE #HPX-P-D-8'-S-S-835-WSOTG-F-UNV-SC-FC-10X-FA50*	LED BY MFR.	54.4	
PF	SMALL EXTERIOR PENDANT WITH BIRD SHROUD AND BATTERY BACKUP.	LSI #OPS-PD-3L-5Q-UNV-40K8-BRZ-CWBB	LED BY MFR.	22	
S	4' LED LENSED STRIP LIGHT WITH 3000 LUMEN OUTPUT, 4000K COLOR TEMPERATURE, CLEAR ROUND ACRYLIC LENS.	HE WILLIAMS #76R-4-L30/840-DIM-UNV	LED BY MFR.	20.3	SURFACE MOUNT TO CEILING, PROVIDE SUPPORT FROM STRUCTURE ABOVE WHEN MOUNTED ON ACET CEILING.

1. LIGHTING FIXTURES, INSTALLATION, SUPPORT, WIRING AND RELATED WORK SHALL COMPLY WITH GENERAL NOTES, FIXTURE SCHEDULE, FIXTURE DETAILS, SPECIFICATIONS AND ALL CONTRACT DRAWINGS.  
2. PROVIDE ALL ACCESSORIES REQUIRED FOR A COMPLETE INSTALLATION AND COORDINATE WITH WORK BY OTHER TRADES. RECESSED FIXTURES (OTHER THAN FIXTURES LOCATED IN LAY-IN GRID CEILING) SHALL BE COMPLETELY SERVICEABLE FROM THE FIXTURE OPENING. PROVIDE ALL REQUIRED MOUNTING HARDWARE, SUPPORTS, ACCESSORIES AND TRIM REQUIRED FOR A COMPLETE INSTALLATION. COORDINATE FIXTURE MOUNTING WITH CEILING AND WALL CONSTRUCTION WHERE INSTALLED. PROVIDE SEPARATION BETWEEN RECESSED FIXTURES AND SURROUNDING INSULATION TO COMPLY WITH UL LISTING REQUIREMENTS AND MANUFACTURER INSTRUCTIONS.  
3. OTHER MANUFACTURERS ACCEPTABLE WHERE EQUIVALENT IN PERFORMANCE AND AESTHETICS. SUBMIT FOR APPROVAL ACCORDING TO SPECIFICATIONS OR IF NOT SPECIFIED, WITH SHOP DRAWINGS.  
4. FIXTURES SHALL BE LISTED AND LABELED BY ETL OR UL FOR DRY, DAMP, WET OR HAZARDOUS/CLASSIFIED LOCATIONS AS APPROPRIATE FOR THE INSTALLATION, UNLESS MORE STRINGENT REQUIREMENTS ARE INDICATED OR SPECIFIED.  
5. WHERE FIXTURES ARE INDICATED ON DRAWINGS TO BE CONNECTED AS NIGHTLIGHTS, CONNECT FIXTURE INPUT (AND BATTERY WHERE APPLICABLE) LINE SIDE OF ANY SWITCHING OR CONTROLS.

EXISTING PANELBOARD SCHEDULE PANEL 2BIL  
208Y/120 VOLTS, 3 PHASE, 4 WIRE, 200 AMP MCB LOCATION: 2ND FLOOR ELECTRICAL ROOM  
EXISTING INTERRUPTING CAPACITY

CIR NO.	CIRCUIT DESIGNATION	TRIP/LOAD	CIR VA	VOLT-AMP/PHASE			CIR VA	TRIP/LOAD	CIRCUIT DESIGNATION	CIR NO.
				PH A	PH B	PH C				
1	HP-1, AH-1	30/2	1903	3806			1903	30/2	HP-2, AH-2	2
3			1903	3806			1903			4
5	EXISTING	20/1	0		0	0	20/1	EXISTING		6
7	EXISTING	20/1	0	0			20/1	EXISTING		8
9	FIRE RATED ROLL UP DOOR	20/1	650		650		0	20/1	EXISTING	10
11	FIRE RATED ROLL UP DOOR	20/1	650			650	0	20/1	EXISTING	12
13	FIRE RATED ROLL UP DOOR	20/1	650	650			0	20/1	EXISTING	14
15	FIRE RATED ROLL UP DOOR	20/1	650		650		0	20/1	EXISTING	16
17	FIRE RATED ROLL UP DOOR	20/1	650			650	0	20/1	EXISTING	18
19	EXISTING	20/1	0	0			0	20/1	EXISTING	20
21	EXISTING	20/1	0		0		0	20/1	EXISTING	22
23	EXISTING	20/1	0			0	0	20/1	EXISTING	24
25	EXISTING	20/1	0	0			0	20/1	EXISTING	26
27	EXISTING	20/1	0		0		0	20/1	EXISTING	28
29	EXISTING	20/1	0			0	0	20/1	EXISTING	30
31	EXISTING	20/1	0	0			0	20/1	EXISTING	32
33	EXISTING	20/1	0		0		0	20/1	EXISTING	34
35	EXISTING	20/1	0			0	0	20/1	EXISTING	36
37	EXISTING	20/1	0	0			0	20/1	EXISTING	38
39	EXISTING	20/1	0		0		0	20/1	EXISTING	40
41	EXISTING	20/1	0			0	0	20/1	EXISTING	42
TOTALS:				4456	5106	1300				
FACTORS:				10862	VA	CONN	208	V (L-L)		
DEMAND				1.0	10862	VA	DEM	30	A (DEM)	

PANEL SCHEDULE NOTES

- \* NEW (HACR) CIRCUIT BREAKER TO MATCH EXISTING TYPE AND FAULT CURRENT RATINGS.
- HATCHING DENOTES EXISTING CIRCUITS IN US AND TO REMAIN "AS-IS"
- \*\* EXISTING 20A/1P CIRCUIT BREAKER TO BE REUSED TO FEED NEW LOAD SHOWN.
- A LOAD OF ZERO (0) INDICATES THAT THE LOAD IS UNKNOWN, IT DOES NOT NECESSARILY INDICATE A LACK OF A LOAD.